

RIONET

HEARING AID **HB-79P**

RION CO., LTD.

3-20-41 Higashimotomachi, Kokubunji, Tokyo 185-8533, Japan

HOW TO USE YOUR FIRST HEARING AID

- Any hearing aid cannot return level of your hearing to normal or halt further hearing deterioration, but proper use of your hearing aid can help you hear what is going on around you and let you get more enjoyment of life.
- If this is your first hearing aid, you - like most new users - will probably be surprised at the loudness of the sounds, and after using it for a short while, you may even feel that it is too noisy. The following three tips are important in overcoming your concerns.
 - 1) Read this manual and become familiar with the hearing aid's various mechanisms and how to use them correctly.
 - 2) First, use your hearing aid in a quiet place and listen to quiet sounds and give yourself sufficient time to get accustomed to the sound of your hearing aid.
 - 3) If any physical problems develop, consult your doctor.

FOR KEEPING YOUR HEARING AID LONGER

- Always keep the hearing aid clean. Clean the hearing aid with dry cloth periodically and also remove earwax plugged in the earpiece or earmold using eyebrush or toothbrush.
- Do not expose the hearing aid to the heat from stoves, etc. Also, avoid leaving it in places with high humidity.
- Operate the controls with care. Do not press hard.
- If the hearing aid is dropped in water, wipe with dry cloth and ask the dispenser for check.
- Do not pick the microphone with nail, pin, etc., because this may damage the microphone.
- Do not disassemble or attempt any repairs by yourself. Ask the dispenser for repair.

OPERATING INSTRUCTIONS

Parts and Controls

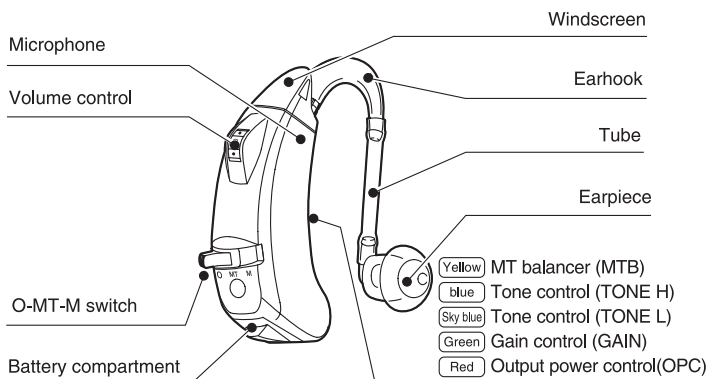

Tube and earpiece shown above are not included as standard accessories in some countries.

Selecting Earpiece

Remove the tube from the earhook. Insert the earpiece into your ear. If this earpiece does not fit your ear, replace it with other one.

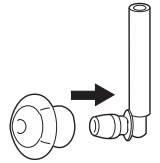

Earmold

The earmold is made just for your own ear, so that it can completely fit your ear. If the earpiece does not fit your ear and whistling occurs, use of the earmold is recommended. Consult your local dispenser.

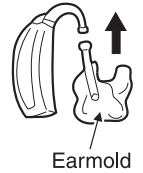

Battery Placement

1. Seal off the sticker on the positive side of battery (PR-44P or 675AP zinc-air battery) before loading. The battery operates normally in about 1 minute after the sealing is removed.
2. Open the battery door.
3. Insert a PR-44P or 675AP battery into the battery compartment with correct polarity; the plus mark on the battery must be matching.
4. Close the battery door tightly.

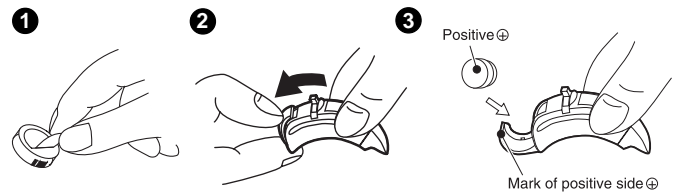

Be sure to remove the battery when the hearing aid is not to be used any time.

Battery life: Approx. 190 hours (IEC), 110 hours (ANSI) (PR44P or 675AP, for continuous use)
Battery life will change depending on the operation condition.

Putting on Hearing aid

1. Hold the hearing aid as shown and put it on your ear.
2. Insert the earmold or earpiece into your ear.

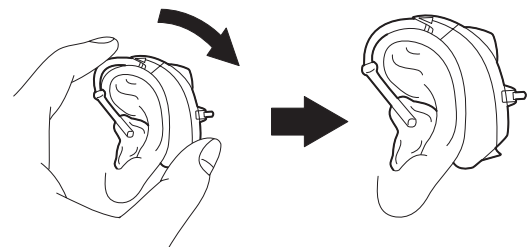

If the earhook does not fit your ear as shown below, consult your local dispenser. Different size of earhooks are available.

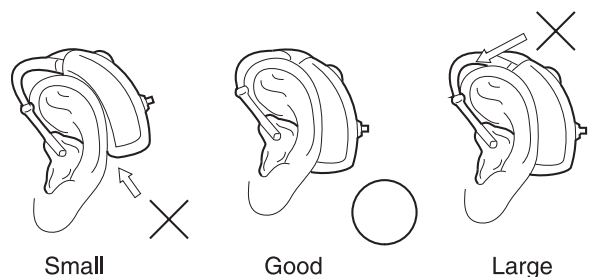

O-MT-M Switch

O: Power Off

Set to "O" when the hearing aid is not in use.

MT: Microphone and Telephone Coil

Sounds through both the microphone and telephone coil can be heard. Set to "MT" position when using your hearing aid for telephone or induction loop system in combination with the MT balancer.

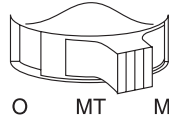

When the switch of the hearing aid is set to MT, noise may be heard in the vicinity of electromagnetic fields, such as generated for example by electronically secured gates or similar.

M: Microphone

Set to "M" for ordinary use.

When taking off the hearing aid, set the switch to "O". If not, whistling (acoustic feedback) may occur.

Volume Control

Adjust the sound volume to your comfortable level with the volume control. The best position of the control will depend upon the distance and voice of the person to whom you are talking; readjustment may be necessary.

When using the hearing aid for the first time, set the control for a minimum sound level to hear, then increase the volume gradually.

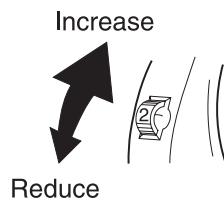

TECHNICAL DATA (According to ANSI Standard S3.22 1987)

Maximum SSPL90		131 dB
HFA-SSPL90		129 dB
HFA-full-on Gain		66 dB
Reference Test Gain		52 dB
Frequency Range		110 Hz to 5900 Hz
Equivalent Input Noise Level		26 dB
Total Harmonic Distortion	500 Hz	3%
	800 Hz	2%
	1600 Hz	1%
Operating Switch		O-MT-M
AGC		OPC
Output Limiting Control		OPC, range 18 dB (continuous)
Tone Control		TONE H, TONE L (continuous)
Gain Control		MAIN + GAIN, range 55 dB
Induction Coil Sensitivity		125 dB at 10 mA/m
Battery Type		675AP or PR44P
Supply Voltage		1.3 V
Battery Current		4.9 mA
Battery Life		110 h
Dimensions		4.9 × 1.64 × 1.02 cm
Weight (excluding battery)		6.5 g (excluding battery)

(Typical value)

Frequency response curve and effect of tone control

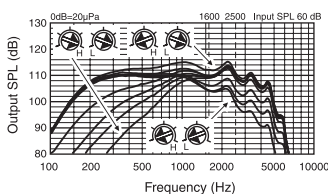

SSPL90 curve and effect of output limiting control

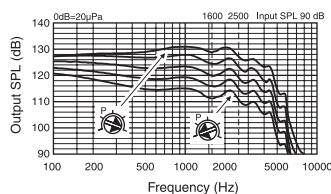

Full-on gain curve

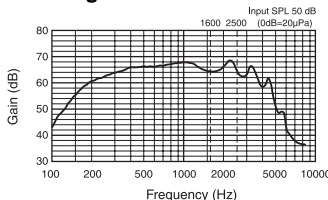

Note:

- (1) Production number (serial number) is indicated at the back side of a hearing aid.
- (2) Manufacturer's name is imprinted at the back side of a hearing aid.

MT BALANCER (MTB)

This control serves to adjust the volume of sounds through the telephone pickup coil when the main operating switch is set to the MT position. Turning it clockwise from the position illustrated on the right side reduces the volume of sounds through the telephone pickup coil. When this is set to the T position, you can only hear the sounds through the telephone pickup coil.



TONE CONTROLS

Tone H (Low Cut)

Turning this control clockwise reduces the amount of low frequency amplification. Maximum reduction at 500 Hz is 18 dB.



Tone L (High Cut)

Turning this control counterclockwise reduces the amount of high frequency amplification. Maximum reduction at 3000 Hz is 12 dB.



GAIN CONTROL (GAIN)

Gain control allows you to increase gain by up to 30 dB. Set the O-MT-M switch to "M" and main volume control to "3", then set this control to the most comfortable sound level by turning it clockwise to increase acoustic gain.



OUTPUT POWER CONTROL (OPC)

This control serves to adjust the maximum output so that your hearing can be protected from sudden loud sounds. The automatic gain control (AGC) action will be activated by turning this potentiometer counterclockwise.



TECHNICAL DATA (According to IEC standard Pub. 118-0-1983)

Reference Test Frequency		1600 Hz
OSPL ₉₀		137 dB
	500 Hz	134 dB
	Peak	140 dB
Full on Acoustic Gain		72 dB
Equivalent Input Noise Level		25 dB
Total Harmonic Distortion	500 Hz	6%
	800 Hz	3%
	1600 Hz	2%
Operating Switch		O-MT-M
AGC		OPC
Output Limiting Control		OPC, range 18 dB (continuous)
Tone Control		TONE H, TONE L (continuous)
Gain Control		MAIN + GAIN, range 55 dB
Induction Coil Sensitivity		112 dB at 1 mA/m
Battery Type		675AP or PR44P
Supply Voltage		1.3 V
Battery Current		2.8 mA
Battery Life		190 h
Dimensions		4.9 × 1.64 × 1.02 cm
Weight (excluding battery)		6.5 g (excluding battery)

(Typical value)

Basic frequency response curve and effect of tone control

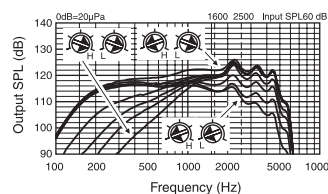

OSPL₉₀ curve and effect of output limiting control

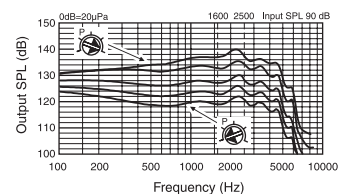

Full-on acoustic gain frequency response curve

